

INSTRUCTIONS FOR REPLACING BEVELED CABLE PULLEYS, EXTENSION SPRINGS, CABLES, AND NYLON CABLE GUIDES

NOTE: THESE INSTRUCTIONS ARE FOR A STANDARD ROLLING TARP THAT LOCKS CLOSED ON THE DRIVER SIDE

NOTE: FOR A REVERSE ROLLING TARP (LOCKS CLOSED ON PASSENGER SIDE) THE FRONT PULLEY WILL BE MARKED FRONT REVERSE AND THE REAR WILL BE MARKED FRONT STANDARD.

ROLL THE TARP TO THE OPEN POSITION.

BEVELED CABLE PULLEY REPLACEMENT

Remove the pulley cap (A) from the front beveled pulley (B). The rear beveled pulley (C) does not have a cap. Using a felt marker, mark the position of the old beveled pulleys. Loosen the two- $\frac{1}{4}$ " set screws (D) that secure the beveled pulleys to the roll tube (E). Disconnect the cables' (F) by removing them from the beveled pulley slots. Remove the old pulleys from the roll tube. The new beveled pulley stamped "FRONT STANDARD" (B) will be installed on the front of the roll tube. The beveled pulley stamped "FRONT REVERSE" (C) will be installed on the rear of the roll tube. Slide the pulleys onto the roll tube, small diameter goes on first. Pull the cable (F) from the rear holdback towards the front reverse beveled pulley. Lock the cable end into the pulley slot and repeat procedure for the front standard pulley. Rotate both pulleys $1\frac{1}{2}$ to 2 turns from their underside. Tighten the pulley $\frac{1}{4}$ " set screws.

Note: When the tarp is in the open position, one complete wrap of cable is required on both beveled pulleys. Secure the pulley cap (A) to the front beveled pulley.

EXTENSION SPRING REPLACEMENT

Remove the nylon cable guide (G) and the hex bolt (H) that is holding the extension spring (I) in place. Pull the cable (F) until the extension spring exits the $1\frac{1}{4}$ " square tubing (J). The cable is secured to the loop in the extension spring just like a key is inserted on a key chain. Remove the cable from the spring and reinstall the cable on to the new extension spring. Slide the extension spring into the $1\frac{1}{4}$ " square tubing (J) until the loop in the spring is visible through the bolt hole. Secure the extension spring (I) to the $1\frac{1}{4}$ " square tubing (J) with the hex bolt (H) and nylon lock nut. To reconnect the cables to the front and rear beveled pulleys see "BEVELED PULLEY REPLACEMENT".

CABLE REPLACEMENT

Remove the nylon cable guide (G) and the hex bolt (H) that is holding the extension spring (I) in place. Pull the cable (F) until the extension spring exits the $1\frac{1}{4}$ " square tubing (J). Removing the cable from the spring is similar to removing a key from a key chain. Remove the old cable and secure the new cable to extension spring. In order to remove the nylon cable guide (G) you must first sever the old cable. Slide the nylon cable guide onto the new cable, making sure the cable guide is facing the right direction. Using a hammer lightly tap the nylon cable guide into the $1\frac{1}{4}$ " square tubing. Crimp the aluminum cable stop (K) to the end of the cable. To reconnect the cables to the front and rear beveled pulleys see "BEVELED PULLEY REPLACEMENT".

NYLON CABLE GUIDE REPLACEMENT

Disconnect the cable (F) from the beveled pulley. Sever the aluminum cable stop (K) from the end of the cable. Remove the nylon cable guide (G) from the $1\frac{1}{4}$ " square tubing (J) and cable. Slide the new nylon cable guide (G) onto the cable and secure it to the $1\frac{1}{4}$ " square tubing.

Note: When reinserting the nylon cable guide (G), do not hit or bend the cable (F).

Crimp the aluminum cable stop (K) to the end of the cable. To reconnect the cables to the front and rear beveled pulleys see "BEVELED PULLEY REPLACEMENT".

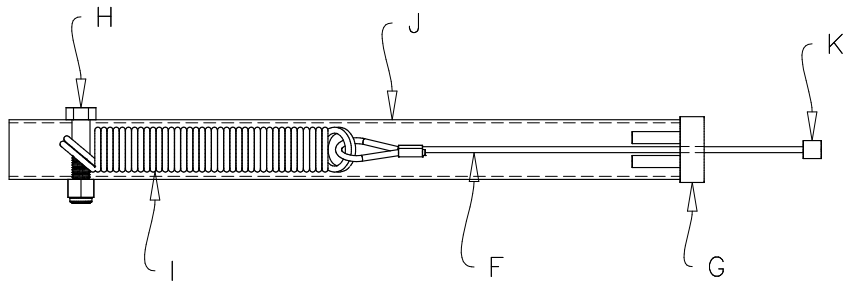
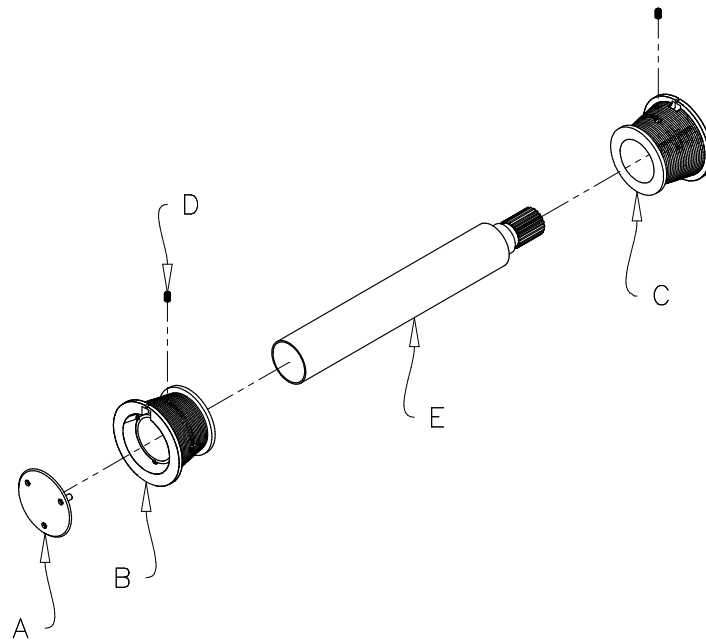

FOR INSTALLATION ASSISTANCE PLEASE CALL COLLECT (306) 366-2184

Michel's Industries LTD.
P.O. Box 119
St. Gregor Sk. S0K 2P0
TEL. (306) 366-2184 FAX (306) 366-2145